

# IOT Parts Replacement

12.01.2021

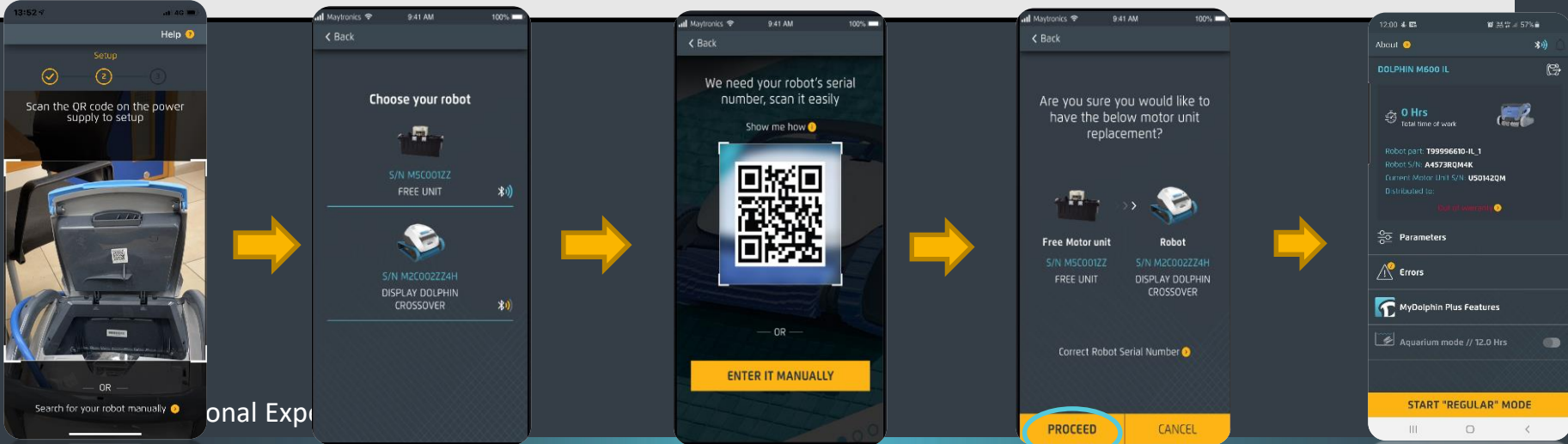

# Motor Unit Replacement for technician

Connection Type	Connection Attempt	Technician Reported Replacement in the warranty system.	Comments
Bluetooth / WIFI	1 <sup>st</sup> time, the technician never connect to this motor unit through WIFI or Bluetooth. 	No Reported.	<ol style="list-style-type: none"><li>1. Open dolphin tech plus.</li><li>2. technician should operate the power supply with the new motor unit serial number.</li><li>3. search for near by robot button in case of M400/500/600, S300i</li><li>4. The app' will recognize only the MU serial number.</li><li>5. The technician must choose "No I don't recognize this robot"</li><li>6. you scan QR code or enter S/N manually.</li><li>7. Confirm MU serial number and robot serial number then press "proceed".</li></ol>
			

# Motor Unit Replacement for end user

Connection Type

Connection Attempt

Technician Reported  
Replacement in the warranty system.

Comments

Bluetooth / WIFI

2<sup>nd</sup> time



No Reported.

1. Open the Mydolphin™ Plus app.
2. The user will see connection error.
3. user should operate the power supply with the new motor unit.
4. Go to app's setting robot details and press "disconnect from this robot".
5. Must Press on "search for nearby robots" to search for your robot.
6. The app' will recognize the robot serial number
7. The customer must choose "Yes this is my robot" (make sure it is your robot serial number)
8. The MU will Linked to robot and the App' can now connect to the customer robot.

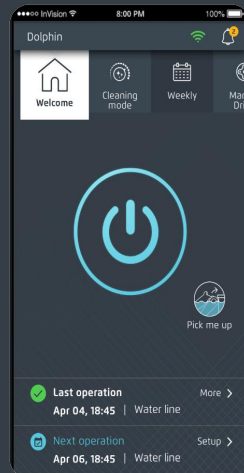
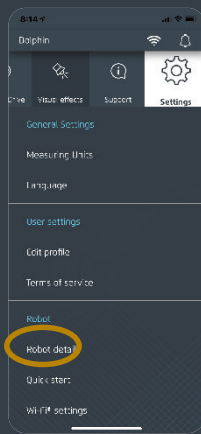
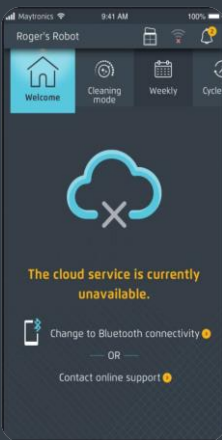

Exceptional Experience

# Motor Unit Replacement

Connection Type	Connection Attempt	Technician Reported Replacement in the warranty system.	Comments
Wi-Fi	2 <sup>nd</sup> time	Reported.	Power Supply “learned” the motor unit serial number.

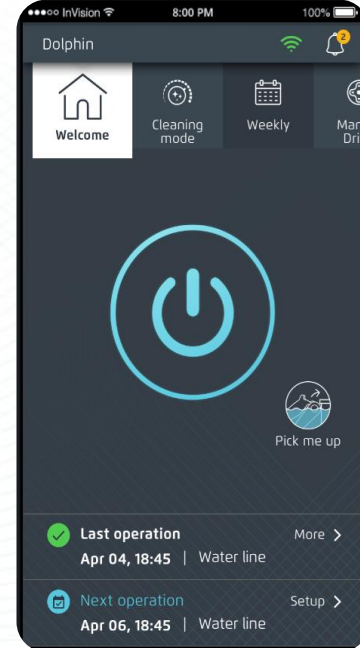

# Power Supply Replacement

Connection Type	Connection Attempt	Comments
Bluetooth/WIFI	1 <sup>st</sup> time	Technician / User did not “teach” the power supply with the MU SN

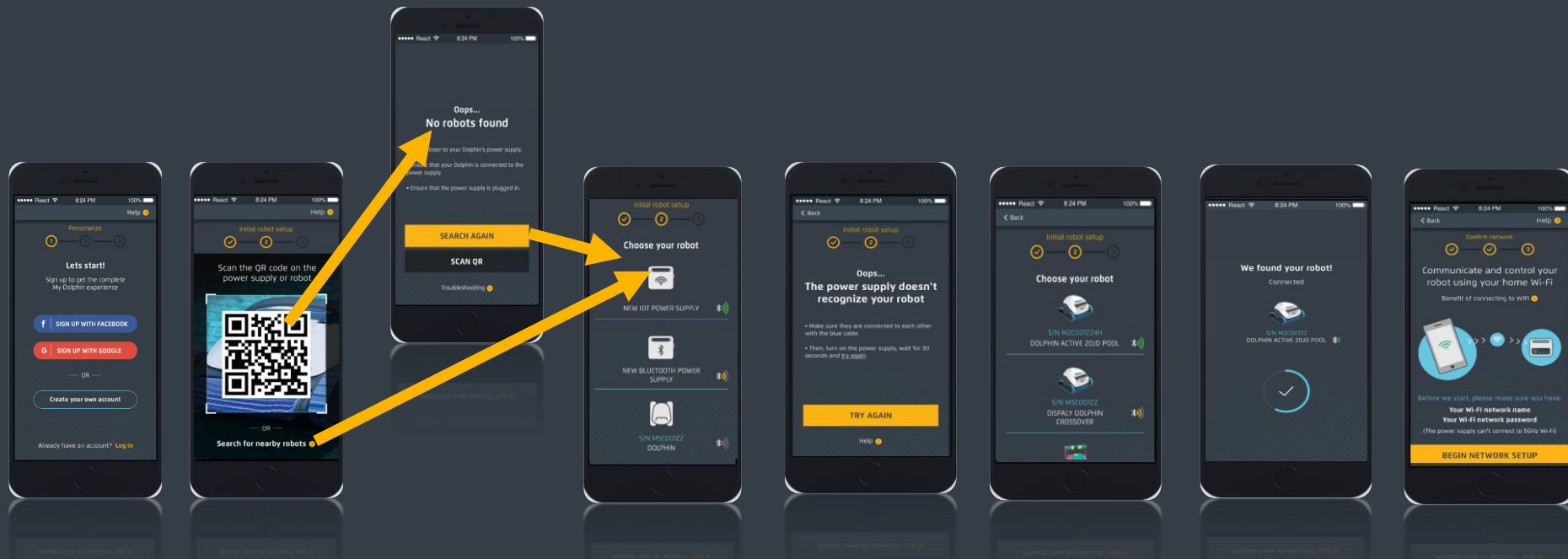

Exceptional Experience



# how to Upgrade Robot to new IOT Power supply & new Mydolphin plus™

Connection Type	Connection Attempt	Comments
Bluetooth + Wi-Fi	1 <sup>st</sup> time	<ol style="list-style-type: none"><li>1. User should download the new Mydolphin™ Plus app.</li><li>2. The user must do complete registration in the application.</li><li>3. Technician or user should “teach” the power supply with the motor unit serial number</li></ol>

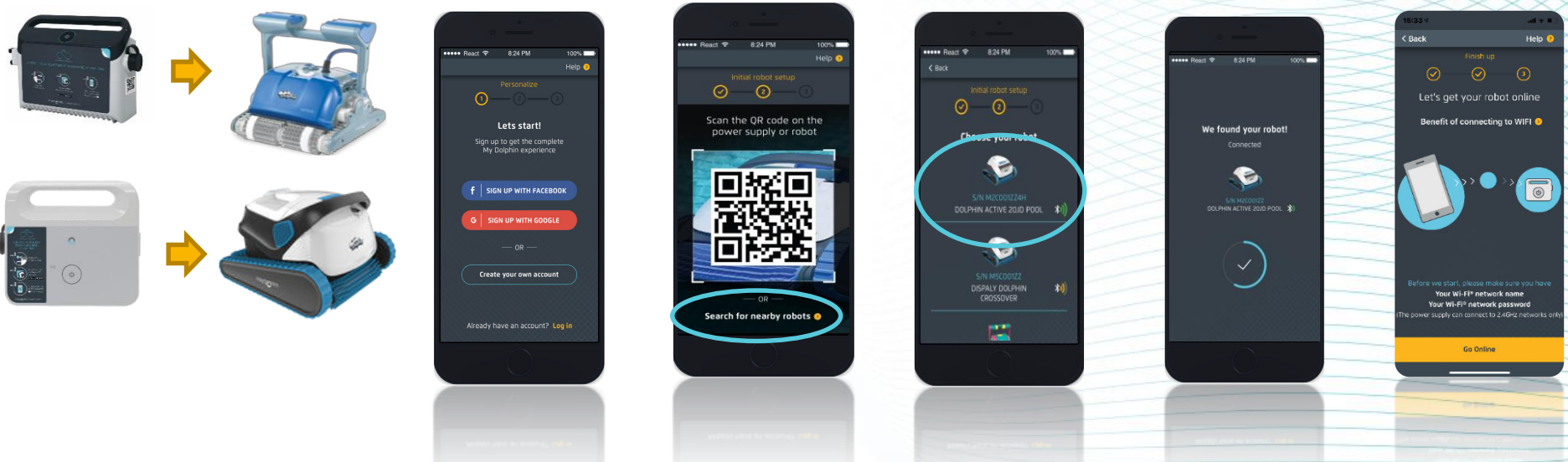

# power supply replacement

Connection Type	Connection Attempt	Comments
Bluetooth + Wi-Fi	1 <sup>st</sup> time	<ol style="list-style-type: none"><li>1. User should download the new Mydolphin™ Plus app.</li><li>2. The user must do complete registration in the application.</li><li>3. Technician or user should “teach” the power supply with the motor unit serial number</li></ol>

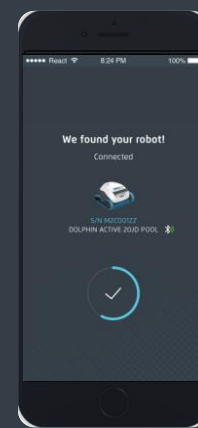
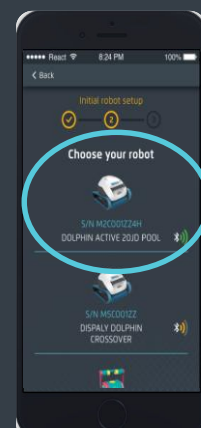
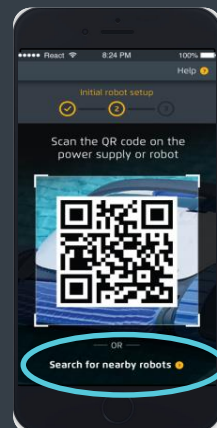
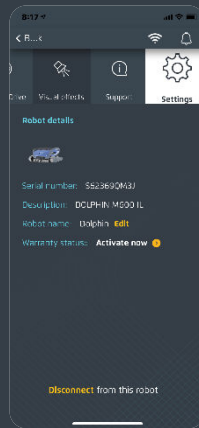
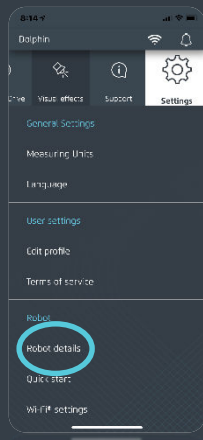
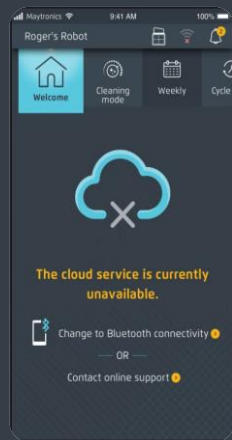

# Change Wi-Fi network

Connection Type	Connection Attempt	Comments
Wi-Fi	2 <sup>nd</sup> time	<ol style="list-style-type: none"><li>1. Open the Mydolphin™ Plus app.</li><li>2. The user will see connection error.</li><li>3. Go to app's setting , WIFI setting press on "change WIFI network.</li><li>4. Choose on new network and enter new password.</li><li>5. Connect to new WIFI network.</li></ol>

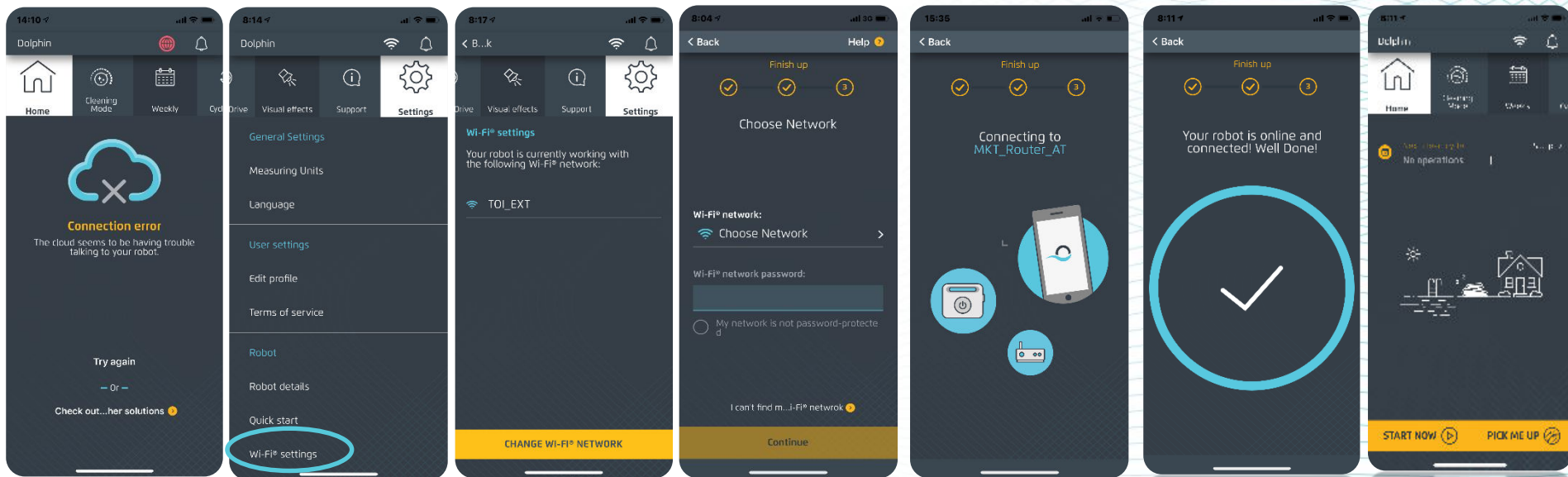



# Upgrade from Bluetooth to Wi-Fi connectivity

Connection Type	Connection Attempt	Comments
Bluetooth & Wi-Fi	2 <sup>nd</sup> time	

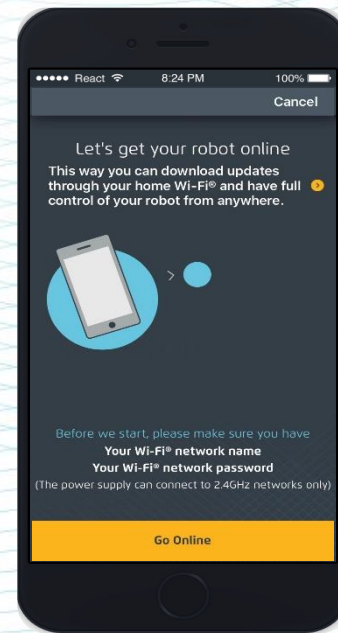
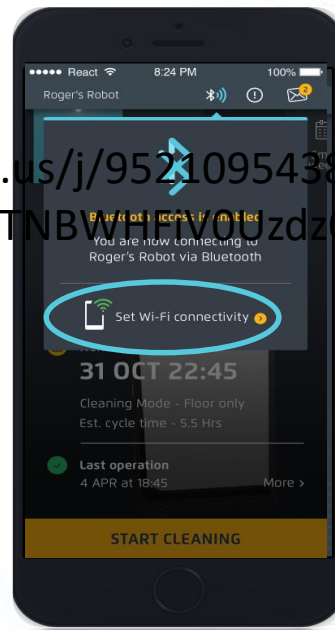
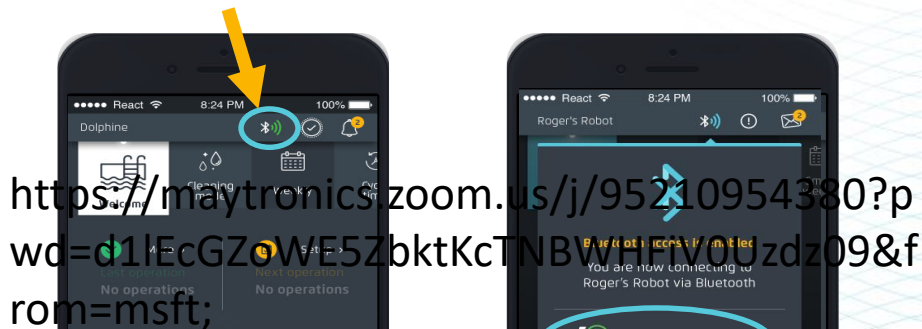
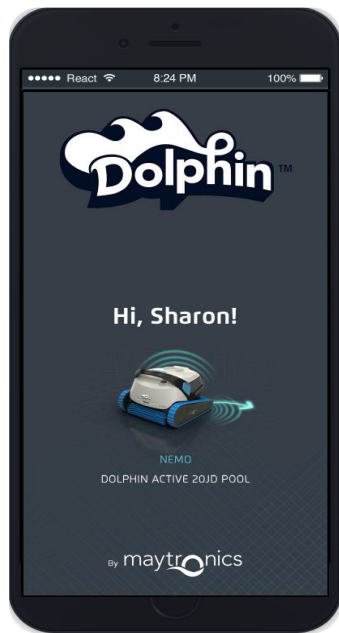

# Self Training

- Download Dolphintech plus
- Replace MU and do pair
- Replace PS



*Exceptional Experience*



*Thank You.*