

6.1. - EXCEPTIONS THAT MAY RESULT IN DENIAL OF A WARRANTY CLAIM:

- 1.- Damage caused by careless handling, improper repackaging or shipping.
- 2.- Damage due to misapplication, misuse, abuse or failure to operate and install the equipment as specified in this manual.
- 3.- Damage caused by a misuse, abuse or failure to operate and install the equipment out of the scope of a professional level demanded in similar equipment or installation type.
- 4.- Damage due to unauthorized product modifications or failure to use Emaux original replacement parts.
- 5.- Damaged caused by negligence or failure to properly maintain products as specified in this manual.
- 6.- Damage caused by failure to maintain water chemistry in conformity with the standards of the swimming pool industry for any length of time.
- 7.- Damage caused by water freezing inside the product.
- 8.- Accident damage, fire or other circumstances outside the control of Emaux.
- 9.- Items had been repaired or altered in any way by any person that is not authorized by Emaux.
- 10.- Wear & tear parts.

6.2.- CLAIM PROCESS:

Summary of Emaux Claim Process in 3 steps:

- a) Claim: Customer contacts Emaux salesperson and provides completed details of the claim which includes:
 - a. Information about the failed product such as the part number(s) and serial number(s).
 - b. Description of the complaint/failure.
 - c. Pictures
- b) Once the complaint is received, the product quality incident will then be reviewed by Emaux's Quality Control Department following the "Emaux Warranty Policy".
- c) Conclusion: After the investigation is completed, Emaux will inform the distributor accordingly.

6.3. - WARRANTY OBLIGATION:

Emaux warrants any of above items from workmanship and/or material(s).

Should a defect become evident during the term of warranty, Emaux will, at its option, repair or replace such item or part at its own cost and expense. Customer will need to follow the warranty claim procedures from Emaux in order to obtain the benefit on this warranty.

Emaux is not, however, responsible under this warranty for any cost of shipping or transportation of the equipment or parts thereof "to" or "from" our technical operations.

Emaux is not able to liable for any loss of time, inconvenience, incidental expenses such as labor cost, phone calls, legal cost or material cost incurred in connection with the replacement or removal of the equipment, or any other consequential or incidental damage on persons or assets. Emaux will be not responsible for any business profit loss operation stop due to the non-conformity product equipment. No indemnity or damages can be claimed on any account whatever.

6.4. - WARRANTY OR REPRESENTATIONS BY OTHERS:

No dealer or other person has authority to make any warranty or representation concerning Emaux or its products.

Accordingly, Emaux is not responsible for any such warranty or representation.



MAIN DRAIN

MANUAL INSTALLATION.

MODELS:

EM2837
EM2838
EM2839
EM2840

MAIN DRAIN

Model: EM2837; EM2838; EM2839; EM2840
Codes: 88142312; 88142412; 88142512; 88142612

IMPORTANT: This instruction manual includes essential information on the safety measures to be implemented for installation and start-up. Therefore, the installer as well as the user must read the instructions before starting installation and start-up.

Keep this manual for future reference

1.- MAIN DRAIN:

Main drains are used to take out water from the deepest part of the pool for the recirculation process. It is also used to drain the pool. (Fig 1)

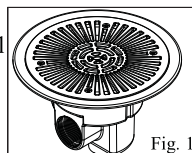

2.- INSTALLATION:

According to the normative, main drains have to be installed asfollowing:

- Main drains have to be installed in the deepest part of the pool.
- The minimum distance between two main drains is 2 meters.
- The minimum distance between the main drain and the wall of the pool is 300 mm.
- The maximum water velocity through the grille is 0.5 m/sec.
- The maximum water velocity in the suction pipe until the filtration pump is 1.5 m/sec.

The flow rate required for the installation will determine the number of main drains needed. The maximum flow rate allowed is 13 m³/h.

3.- MODELS:

		Concrete pools		Vinyl pools with Liner	
		EM2838	EM2839	EM2837	EM2840
Metric connections	Suction Circuit	G2"		G2 "	
	Hydrostatic valve connection *	Ø 50 mm		Ø 50 mm	
Imperial connections	Suction Circuit	G2"		G2"	
	Hydrostatic valve connection *	Ø 1 ½"		Ø 1 ½"	

* Emaux Water Technology Co., Ltd. recommends to install a hydrostatic valve (not included) on the lower outlet of the main drain (BSP thread 1 ½"), in order to relieve the pressure that potential ground-water might exert on the pool structure, especially when it is empty or it is Vinyl pool.

4.- WARNINGS: SUCTION ENTRAPMENT HAZARD.

Suction in suction outlets and/or suction outlet covers which are damaged, broken, cracked, missing, or unsecured can cause severe injury or death due to the following entrapment hazards:

- 4.1.- Hair Entrapment - Hair becomes knotted or snagged in an outlet cover.
- 4.2.- Limb Entrapment - A limb sucked or inserted into an opening of a circulation outlet with a broken or missing cover in the pool resulting in a mechanical bind or swelling

4.3.- Body Suction Entrapment - Suction applied to a large portion of the body or limbs resulting in an entrapment.

4.4.- Mechanical Entrapment - Potential for jewelry, swimsuit, hair decorations, finger, toe or knuckle to be caught in an opening of an outlet or cover.

5.- SPARE PARTS LIST:

POS.	CODE	PRODUCT DESCRIPTION
1	03012109	Screws M5x24
2	01050195	Lid
3	03012110	Screws M6x24
4	01050196	Facering
5	02010278	Liner gaskets
6	01050197	Body

POS.	CODE	PRODUCT DESCRIPTION
1	03017125	Screws M5x10
2	01050195	Lid
3	01050198	Body

POS.	CODE	PRODUCT DESCRIPTION
1	03012108	Screws M5x30
2	01050199	Lid
3	01050200	Body

POS.	CODE	PRODUCT DESCRIPTION
1	03012111	Screws M5x45
2	01050199	Lid
3	03011322	Screws M5x25
4	01050201	Facering
5	02010282	Liner gaskets
6	01050202	Body

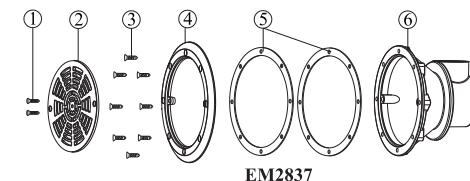

EM2837

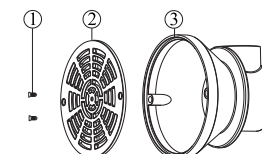

EM2838

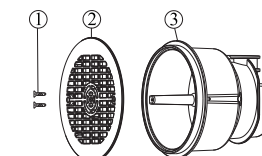

EM2839

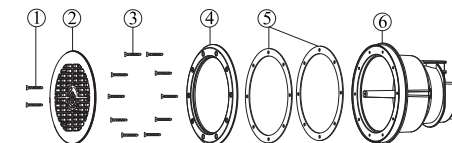

EM2840

6. - WARRANTY POLICY:

Emaux manufactures its products with the highest standard of workmanship, using the best materials available through state of the art process. Emaux proudly warrants its products as follows:

EXTENDED WARRANTY FOR SPECIFIC PRODUCTS (OFFERED FROM DATE OF INVOICE).	
Product	Warranty Period
Filters & Filter Systems	2 years
Pumps	1 year
Underwater Lights	1 year (bulbs 90 days)
Ladders	1 year
Control devices	1 year
Heat Pumps & Heat Exchangers	1 year
Salt Chlorinators & UV Systems	1 year (2 years for cell material)
Pool Fittings	1 year
Cleaning Equipment & All others	1 year