

E-Lumen X Series Underwater Light

True Color RGB with Warm White and Cool White LED
Synchronize color settings of 2 zones by ColorTouch Control System



 **Emaux**
water technology

Pool & Spa Equipment

NEW

E-Lumen X Series Underwater Light

Synchronize color settings of 2 zones by ColorTouch Control System



e-Lumen X

Waterproof Standard

IP68

Cable

2.5m

Installation

**Concrete Wall Mount / Retrofit
Concrete Niche / Fiberglass / Vinyl Pool**

Installation

Plastic ABS/Stainless Steel/Transparent

Color



RGB



LED Blue



LED
Warm White



LED
Cool White

TRUE COLOR RGB WITH WARM WHITE AND COOL WHITE LED

1. The light incorporates five basic colors of LED chips: cool white, warm white, red-green-blue (RGB), with high power and constant color rendering over time and temperature.
2. Equipped with state-of-the-art LED technology, E-Lumen X ensures increased energy and luminous efficacy achieving 80 lumens per watt.
3. LED life exceeds 40,000 hours.
4. The innovative design of the diffusion lens and bulb matrix provides exceptional reflection, brightness, throw, and angle of illumination.
5. The perforations on the face ring contribute to the light intensity and angle of illumination by allowing a light penetration throughout.
6. Self determined operation mode with or without Color-Touch controller.
7. Automatic color synchronization among lights and zone.

E-Lumen X- “Quartz” Series

For all types of pools



Emaux iconic wall-mounted high power LED light

QUARTZ wall-mounted light offers a perfect solution for any pool installations. Its easy mounting kit enables instant installations of new build pools or retro-fit. The retro-fit version is designed to adapt your existing wiring and power and upgrade your pool with fabulous lighting effects under high energy efficiency.

Product Dimensions and Technical Information

| Code | Description | Face Ring |
|---------|--------------------------------|-----------------|
| 9042601 | Quartz Light 12~32V AC 50/60Hz | White |
| 9042602 | Quartz Light 12~32V AC 50/60Hz | Grey |
| 9042603 | Quartz Light 12~32V AC 50/60Hz | Blue |
| 9042604 | Quartz Light 12~32V AC 50/60Hz | Stainless Steel |
| 9042605 | Quartz Light 12~32V AC 50/60Hz | Transparent |

Pool Light Protection Rating : IP68 to 2m depth
Power Consumption :25W

| Color | Operation Voltage | illuminance (Lux) | Color Temperature |
|------------|-------------------|-------------------|-------------------|
| Cool White | 12~32V AC 50/60Hz | 350 | 6500K |
| Warm White | 12~32V AC 50/60Hz | 325 | 3000K |

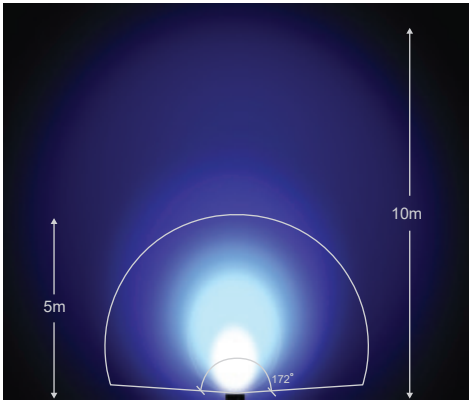

Angle and distance of illumination

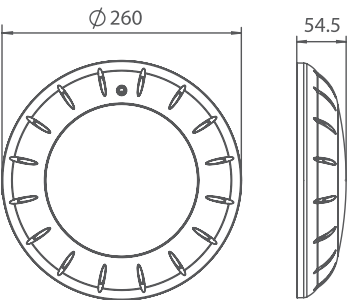

Face Ring Color Options



E-Lumen X- “Quartz (EM)” Series

For installation with inlet nozzles

High adaptable wall-conduit pool light

The Quartz (EM) lights has the same advanced features as E-Lumen X. The inlet nozzle screw-in design for wall conduit and fitting is adaptable for different pool installation options.

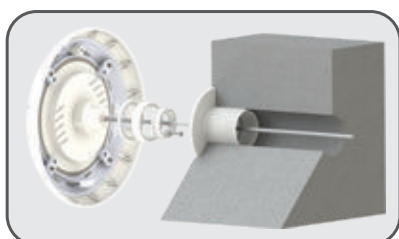

Concrete Pool

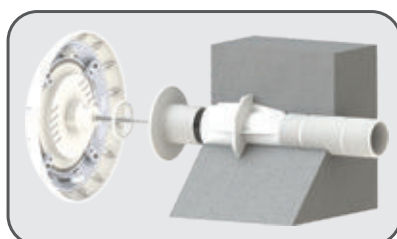

Concrete Pool with Conduit

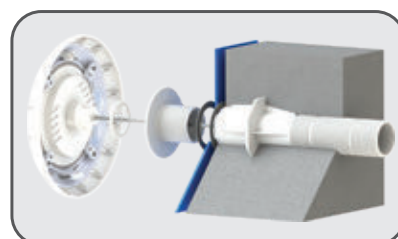

Concrete Pool+Liner

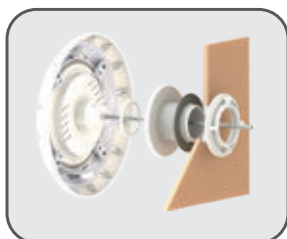

Vinyl Pool Fiberglass Pool

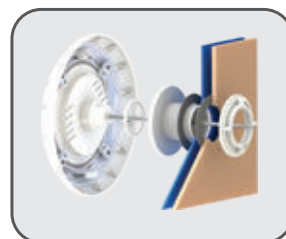

Panel Pool Timber Pool

Wall conduct and fitting accessory for pool type:

| Concrete Pool with 1.5" PVC Pipe | Concrete Pool with Conduit | Concrete pool with Liner | Vinyl / Fiberglass | Panel / Timber |
|----------------------------------|----------------------------|--------------------------|--------------------|----------------|
| EM2831 | EM2831 | EM2831 | EM2836 | EM2836 |
| | EM2841 | EM2841 | | |
| | EM2842 | EM2842 | | |

Product Dimensions and Technical Information

| Code | Description | Face Ring |
|---------|-------------------------------------|-----------------|
| 9042606 | Quartz (EM) Light 12-32V AC 50/60Hz | White |
| 9042607 | Quartz (EM) Light 12-32V AC 50/60Hz | Grey |
| 9042608 | Quartz (EM) Light 12-32V AC 50/60Hz | Blue |
| 9042609 | Quartz (EM) Light 12-32V AC 50/60Hz | Stainless Steel |
| 9042610 | Quartz (EM) Light 12-32V AC 50/60Hz | Transparent |

Dimensions(mm):

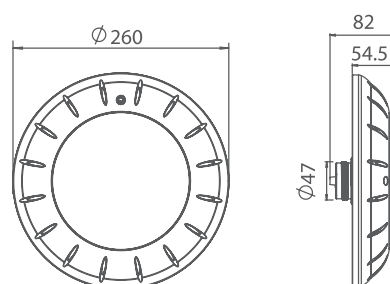

E-Lumen X- “Zircon” Series

For concrete pool with niche or fiberglass pool installation

High illumination compact pool light

ZIRCON is a powerful 25W LED light engineered for concrete and fiberglass pools. The niche or the locknut design provides ease and flexibility enabling a quality installation.



Concrete Pool Niche



ZIR25-C

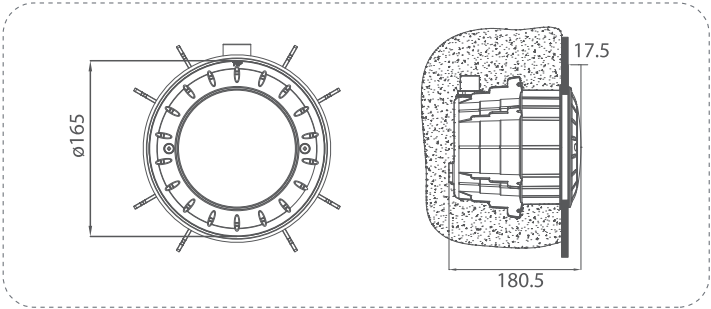

Fiberglass Pool Nut



ZIR25-V

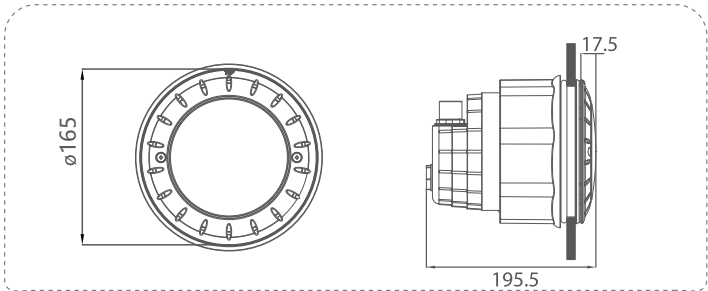

Product Information

Zircon Light 12Vac 50/60Hz, Power cord length with retrofit connector: 2.5m

| Code | Model | Maximum Power | illuminance (Lux) | Color Temperature |
|---------|---------|---------------|--------------------------------------|-------------------|
| 9042801 | ZIR25-C | 25W | 350 (Cool White) 325 (Warm White) | 6500K 3000K |
| 9042802 | ZIR25-V | 25W | 350 (Cool White) 325 (Warm White) | 6500K 3000K |

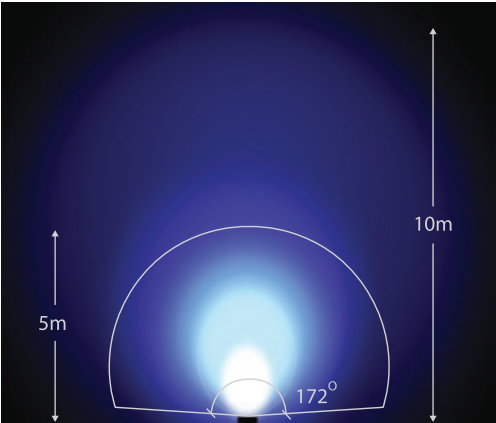

Angle and distance of illumination

E-Lumen X- "Topaz" Series

For concrete pools with niche, fiberglass pools, and vinyl liner pools installations

Slim fit LED light for multi-installation

TOPAZ is a compact and powerful 13W LED light. Its slim construction and multi-installation mechanisms allow it to be fitted into pools and spas of any dimensions, providing a superb lighting effect.



Vinyl Pool

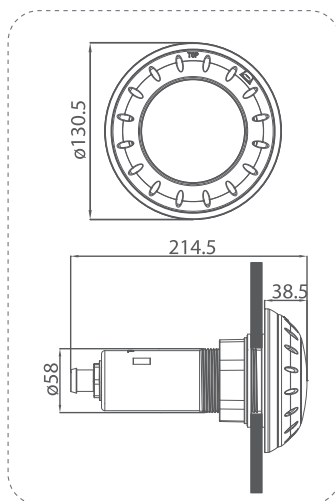

TOP13-VS

Fiberglass Pool

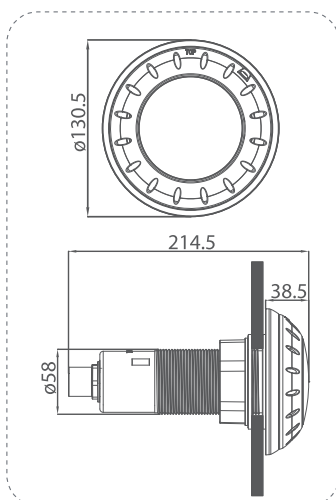

TOP13-VL

Concrete Pool

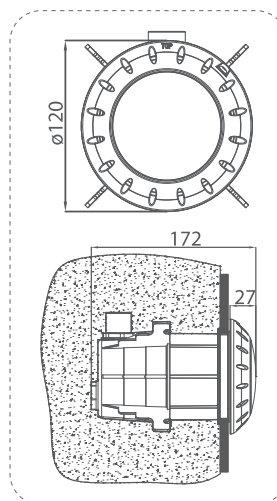

TOP13-C

Concrete Pool

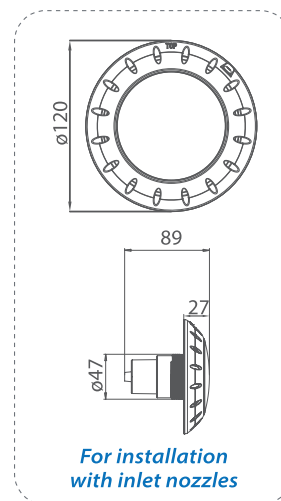

For installation with inlet nozzles



TOP13-EM

Product Information

TOPAZ light 12Vac 50/60Hz, Power cord length with retrofit connector: 2.5m

| Code | Model | Maximum Power | illuminance (Lux) | Color Temperature |
|---------|----------|---------------|-------------------|-------------------|
| 9042701 | TOP13-C | 13W | 220 (Warm White) | 3000K |
| 9042702 | TOP13-VL | 13W | 200 (Cool White) | 6500K |
| 9042703 | TOP13-VS | 13W | | |
| 9042704 | TOP13-EM | 13W | | |

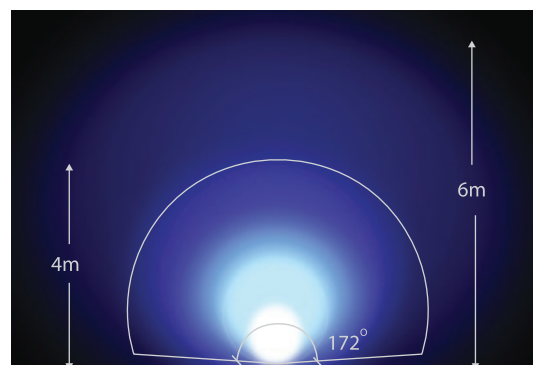

Angle and distance of illumination

ColorTouch Light Control Box

For E-Lumen X Series Underwater Lights



DOWNLOAD THE APP

SMART
LIFE



IoT Connection: An IoT version can be controlled and monitored over an internet connection, enabling users to manage lighting remotely. This connectivity allows for real-time color and brightness adjustments, and automated scheduling in home lighting.

Wi-Fi connectivity:



1. IEEE802.11, 2.4GHz, b/g/n
2. Internal antenna, open area 50m

Features

1. ColorTouch control box not only supports all E- Lumen X series lamp with direct color change and brightness adjustment, but also supports E-lumen ON/OFF switch type for changing lamp color.
2. Provides direct light color change and two zones synchronized color control.
3. By using the existing two-core wires and 12Vac power system. ColorTouch becomes an ideal choice for most pool retrofit and refurbishment projects.
4. Waterproof Standard IP44.
5. The hand-held remote-controller which is compact, user-friendly and water resist. It operates up to 50m in open area.
6. One-touch light effect selection feature though remote-controller: 7 different colors, auto-color changing, and 3 brightness level selection.
7. IoT Connection edition provides all control features as a remote controller over a smartphone through the Apps.
8. Easy to use - Connect Wi-Fi (Home network with internet connection), open Smart Life app (Android and iOS) and use.
9. The Apps can show current color controlling by Colortouch on your smartphone.
10. The Time Schedule function can enable you to define time-based rules by the Smart Life App and trigger your ColorTouch for certain actions automatically.

| Code | Model | Description |
|---------|----------------|---|
| 9110901 | ColorTouch | ColorTouch Control Box 220V with Touch Remote |
| 9110907 | ColorTouch IoT | ColorTouch Control Box 110-220V with Touch Remote & Tuya Wi-Fi (China, Europe, Australia) # |
| 9110908 | ColorTouch IoT | ColorTouch Control Box 110-220V with Touch Remote & Tuya Wi-Fi (USA,Canada) # |

#Please contact our sales representative to verify whether the Wi-Fi channel code is compatible with the ColorTouch device you intend to purchase.

Synchronize color settings of 2 zones by ColorTouch Control System

1. ColorTouch control system can control different modes of lighting in two separate zones at the same time.
2. Each zone can support pool light fixture upto 300VA.
3. Simple one-touch button can instantly synchronize both zones.

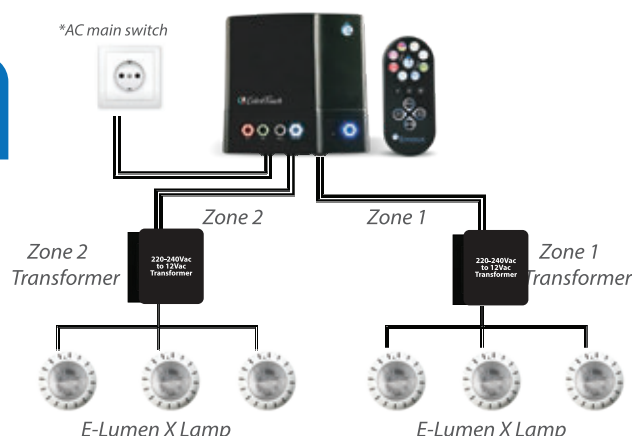



HEAD OFFICE

40/2 Moo.14 KingKaew Rd, Rachatheva,
Bangplee, Samutprakarn, 10540 Thailand
Tel 0-2738-5088-98
Fax 0-2738-5299
Email projects@poolspa.co.th
sales@poolspa.co.th

โชว์รูมและสำนักงานใหญ่

40/2 หมู่ 14 ถนนกิ่งแก้ว ตำบลราชาเทวะ
อำเภอบางพลี จังหวัดสมุทรปราการ 10540
โทร 0-2738-5088-99
แฟกซ์ 0-2738-5299
อีเมล projects@poolspa.co.th
sales@poolspa.co.th



www.poolspa.co.th [poolspathailand](https://www.instagram.com/poolspathailand)