

## Parts of MU Series Ladder Models: NMU & MUF

[Back to Table of Content](#)

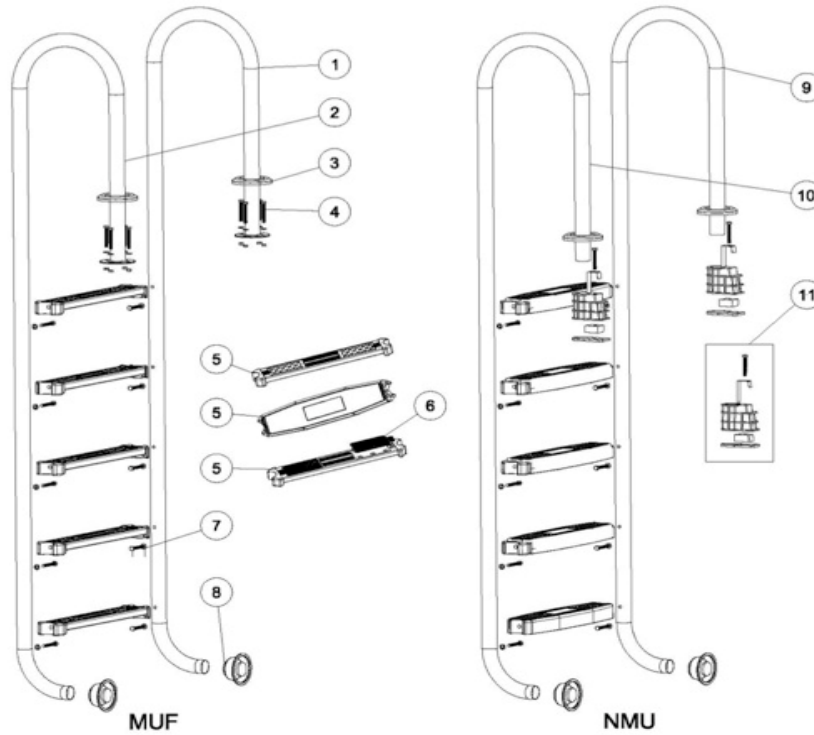

KEY NO.	POOLSPA CODES	PARTNO.	DESCRIPTIONS	PIECE(S) REQUIRED	RETAIL PRICE 2024
1	21830510385	03016137	Ladders Left Hand-Side (AISI304) for MUF215 (Flange)	1	-
1	21830510390	03016138	Ladders Left Hand-Side (AISI304) for MUF315 (Flange)	1	-
1	21830510395	03016139	Ladders Left Hand-Side (AISI304) for MUF415 (Flange)	1	-
1	21830510400	03016140	Ladders Left Hand-Side (AISI304) for MUF515 (Flange)	1	-
1	21830510405	03016204	Ladders Left Hand-Side (AISI316) for MUF215 (Flange)	1	-
1	21830510410	03016205	Ladders Left Hand-Side (AISI316) for MUF315 (Flange)	1	-
1	21830510415	03016206	Ladders Left Hand-Side (AISI316) for MUF415 (Flange)	1	-
1	21830510420	03016207	Ladders Left Hand-Side (AISI316) for MUF515 (Flange)	1	-
2	21830510425	03016141	Ladders Right Hand-Side (AISI304) for MUF215 (Flange)	1	-
2	21830510430	03016142	Ladders Right Hand-Side (AISI304) for MUF315 (Flange)	1	-
2	21830510435	03016143	Ladders Right Hand-Side (AISI304) for MUF415 (Flange)	1	-
2	21830510440	03016144	Ladders Right Hand-Side (AISI304) for MUF515 (Flange)	1	-
2	21830510445	03016208	Ladders Right Hand-Side (AISI316) for MUF215 (Flange)	1	-
2	21830510450	03016209	Ladders Right Hand-Side (AISI316) for MUF315 (Flange)	1	-
2	21830510455	03016210	Ladders Right Hand-Side (AISI316) for MUF415 (Flange)	1	-
2	21830510460	03016211	Ladders Right Hand-Side (AISI316) for MUF515 (Flange)	1	-
3	21830510085	03016046	Cover	2	660.00
4	21830510090	89071801	M8*50 Screw with Washer & Nut for Flange	8	280.00
5*	21830510095	89070102	Ladders Stainless Steel Step (AISI304)	*	2,420.00
5*	201830510100	89070105	Ladders Stainless Steel Step (AISI316)	*	-
5*	21830510105	01051173	Ladders Plastic Step	*	1,320.00
5*	21830510300	89070107	Ladders Stainless Steel Step (AISI316) with Anti-Slippery Pad	*	-
5*	21830510110	89070108	Ladders Stainless Steel Step (AISI304) with Anti-Slippery Pad	*	1,760.00
6	21830510115	02141006	Anti-Slippery Pad	*	150.00
7	21830510120	112000069	M8*35 Screw with Washer for Step (AISI304)	*	150.00
7	21830510125	112010126	M8*35 Screw with Washer for Step (AISI316)	*	-
8	21830510130	89070104	Cap	2	280.00
9	21830510465	03016085	Ladders Left Hand-Side (AISI304) for NMU215	1	-

9	21830510470	03016086	Ladders Left Hand-Side (AISEB04) for NMU315	1	-
9	21830510475	03016087	Ladders Left Hand-Side (AISEB04) for NMU415	1	-
9	21830510480	03016088	Ladders Left Hand-Side (AISEB04) for NMU515	1	-
9	21830510485	03016172	Ladders Left Hand-Side (AISEB16) for NMU215	1	-
9	21830510490	03016173	Ladders Left Hand-Side (AISEB16) for NMU315	1	-
9	21830510495	03016174	Ladders Left Hand-Side (AISEB16) for NMU415	1	-
9	21830510500	03016175	Ladders Left Hand-Side (AISEB16) for NMU515	1	-
10	21830510505	03016089	Ladders Right Hand-Side (AISEB04) for NMU215	1	-
10	21830510510	03016090	Ladders Right Hand-Side (AISEB04) for NMU315	1	-
10	21830510515	03016091	Ladders Right Hand-Side (AISEB04) for NMU415	1	-
10	21830510520	03016092	Ladders Right Hand-Side (AISEB04) for NMU515	1	-
10	21830510525	03016176	Ladders Right Hand-Side (AISEB16) for NMU215	1	-
10	21830510530	03016177	Ladders Right Hand-Side (AISEB16) for NMU315	1	-
10	21830510535	03016178	Ladders Right Hand-Side (AISEB16) for NMU415	1	-
10	21830510540	03016179	Ladders Right Hand-Side (AISEB16) for NMU515	1	-
11	21830510215	89070101	Anchor Type Fittings (Concrete Pool)	2	700.00

Notes: NMU&MUF215-S need 2pcs of Ladder Stainless Steel step and 4pcs of M8\*35 Screw with Washer for Step (AISEB04 or AISEB16)  
 NMU&MUF315-S need 3pcs of Ladder Stainless Steel step and 6pcs of M8\*35 Screw with Washer for Step (AISEB04 or AISEB16)  
 NMU&MUF415-S need 4pcs of Ladder Stainless Steel step and 8pcs of M8\*35 Screw with Washer for Step (AISEB04 or AISEB16)  
 NMU&MUF515-S need 5pcs of Ladder Stainless Steel step and 10pcs of M8\*35 Screw with Washer for Step (AISEB04 or AISEB16)  
 NMU&MUF215-SR need 2pcs of Ladder Stainless Steel Step with Anti-Slippery Pad and 4pcs of Anti-Slippery Pad and 4pcs of M8\*35 Screw with Washer for Step (AISEB04 or AISEB16)  
 NUM&MUF315-SR need 3pcs of Ladder Stainless Steel Step with Anti-Slippery Pad and 6pcs of Anti-Slippery Pad and 6pcs of M8\*35 Screw with Washer for Step (AISEB04 or AISEB16)  
 NUM&MUF415-SR need 4pcs of Ladder Stainless Steel Step with Anti-Slippery Pad and 8pcs of Anti-Slippery Pad and 8pcs of M8\*35 Screw with Washer for Step (AISEB04 or AISEB16)  
 NUM&MUF515-SR need 5pcs of Ladder Stainless Steel Step with Anti-Slippery Pad and 10pcs of Anti-Slippery Pad and 10pcs of M8\*35 Screw with Washer for Step (AISEB04 or AISEB16)  
 NUM&MUF215-P need 2pcs of Ladder Plastic Step and 4pcs of M8\*35 Screw with Washer for Step (AISEB04 or AISEB16)  
 NUM&MUF315-P need 3pcs of Ladder Plastic Step and 6pcs of M8\*35 Screw with Washer for Step (AISEB04 or AISEB16)  
 NUM&MUF415-P need 4pcs of Ladder Plastic Step and 8pcs of M8\*35 Screw with Washer for Step (AISEB04 or AISEB16)  
 NUM&MUF515-P need 5pcs of Ladder Plastic Step and 10pcs of M8\*35 Screw with Washer for Step (AISEB04 or AISEB16)